



Pinnacle Peak Place

8525 East Pinnacle Peak Road | Scottsdale, Arizona

Mike Kitlica
First Vice President
602.468.8559
mkitlica@brephoenix.com

2375 E Camelback Rd Ste 300
Phoenix, Arizona 85016
p 602.954.9000
f 602.468.8588
www.brephoenix.com

**Cassidy
Turley** / BRE
Commercial

Pinnacle Peak Place 8525 East Pinnacle Peak Road | Scottsdale, Arizona

Building Features:

- Property Type: 1-story, Class 'B' Office Building
- Size: ±22,342 RSF
- Total Parking Ratio: 4.1/1,000 SF
- Covered Parking Ratio: 2.4/1,000 SF
- Tenant Improvements: Negotiable
- Expenses: Base Year
- Year Built: 1999

Area Amenities

- Located in North Scottsdale in the prestigious Pinnacle Peak market
- Surrounded by the upscale, master-planned communities of Troon, Estancia and DC Ranch
- High visibility frontage on Pinnacle Peak Road
- Quality tenancy including Northern Trust Bank, Coldwell Banker and Equity Title Agency
- Quality improvements with an appeal oriented towards the high-image corporate user
- Meticulously maintained and frequently upgraded

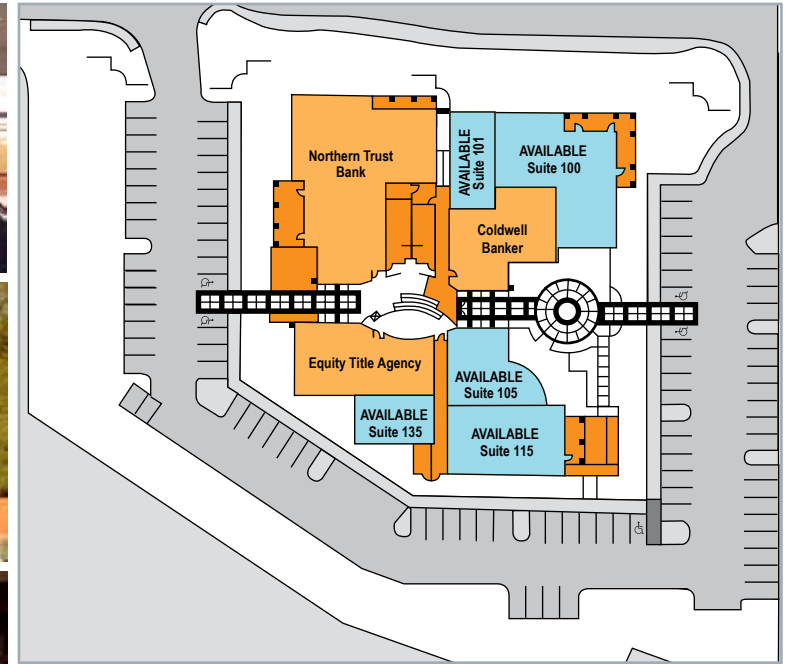

Mike Kitlica
First Vice President
602.468.8559
mkitlica@brephoenix.com

2375 E Camelback Rd Ste 300
Phoenix, Arizona 85016
p 602.954.9000
f 602.468.8588
www.brephoenix.com

**Cassidy
Turley** / BRE
Commercial