

Southpoint Shopping Center

630 - 836 East Rand Rd., Arlington Heights, IL 60004

Property managed by Inland Continental Property Management Corp.

Property Highlights

Center Size: 80,132 SF

- Prime location on heavily trafficked thoroughfare in established retail corridor
- Great visibility and signal-controlled access from Rand Road
- Shadow-anchored by Garden Fresh and Furniture Direct
- Strong traffic counts:
Palatine Road: 24,900 CPD
Rand Road: 31,100 CPD



The Inland name and logo are registered trademarks being used under license.



www.inlandgroup.com

Leasing Contact: Sonya Hene

sonya.hene@inlandgroup.com 800.214.7500

Southpoint Shopping Center

630 - 836 East Rand Road, Arlington Heights, IL 60004

Property managed by Inland Continental Property Management Corp.

STORE LISTING

Center Size: 80,132 Sq. Ft.

Unit #	Sq. Ft.	Tenant
1	1,800	Available
2	1,133	Hair Studio 626
3	8,900	Laser Quest
4	1,200	Available
5	1,668	Available
6	1,666	Available
7	1,066	Available
14	3,800	Available
15	3,400	Available
16	11,479	Coldwell Banker
17	1,135	Prestige Cleaners
18	2,270	Available
19	1,495	Available
20	2,265	Available
22	2,623	Available
23	9,010	Olive Garden
24	5,995	Chili's Restaurant
25	2,632	Pearle Vision
26	2,985	Available
27	1,190	Subway Restaurant
28	3,028	American Mattress
29	4,003	Next Door & Window Co.
30	2,981	Sprint
35	2,400	Available

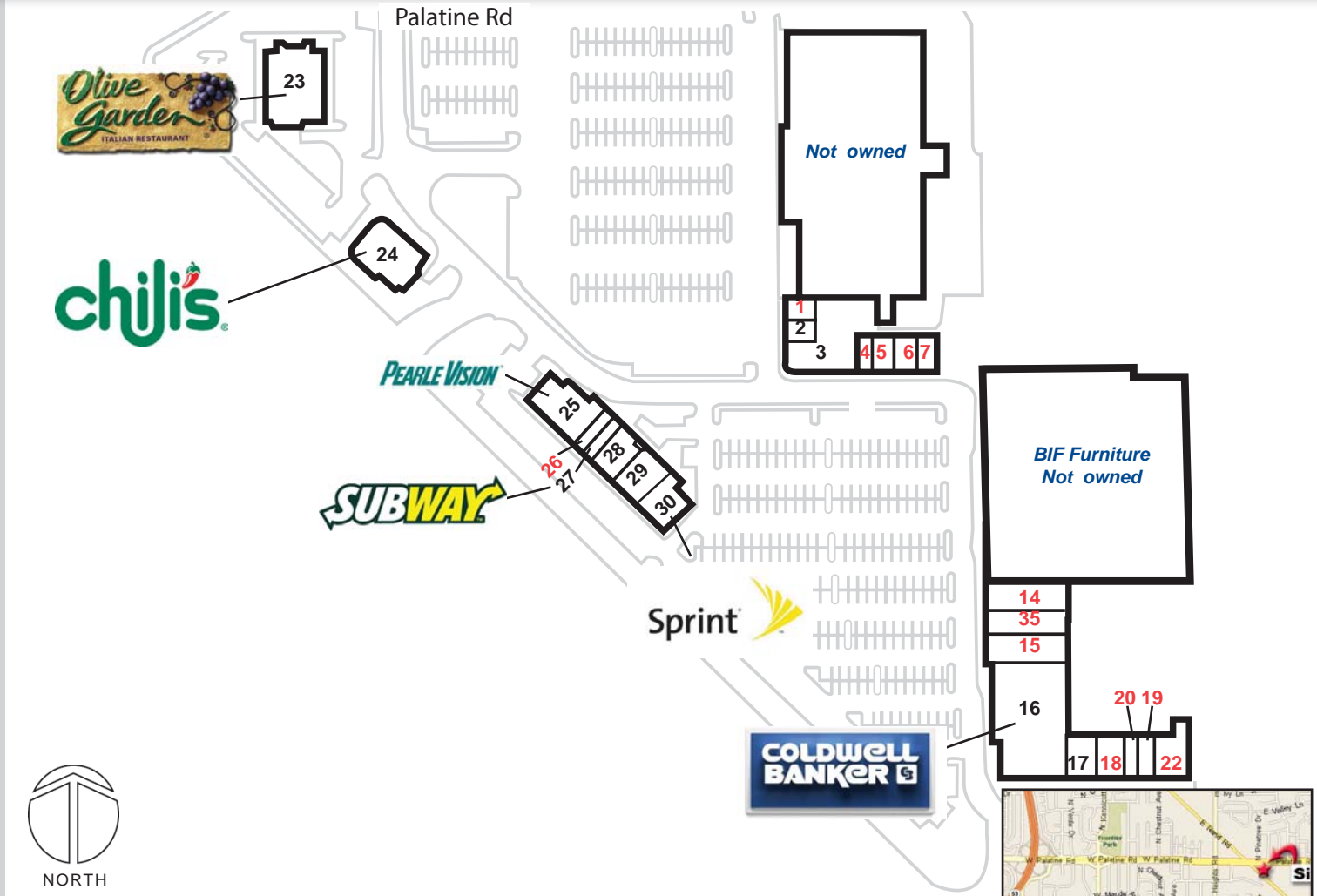

Items in blue and italicized are owned by others.

2014 Demographics Estimate

• Resident Population	• Average HH Income
1 Mile 12,862	1 Mile \$103,922
3 Mile 133,484	3 Mile \$91,087
5 Mile 328,920	5 Mile \$90,023
• Households	• Growth 2010-2012
1 Mile 12,862	1 Mile 0.14%
3 Mile 133,484	3 Mile 0.30%
5 Mile 328,920	5 Mile 0.38%



6/2014

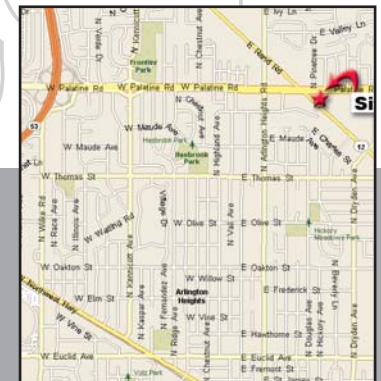

The Inland name and logo are registered trademarks being used under license.