

OLD TOWN  
SCOTTSDALE  
OFFICE FOR LEASE

7329-7335 E. 6TH AVE | SCOTTSDALE, AZ 85251

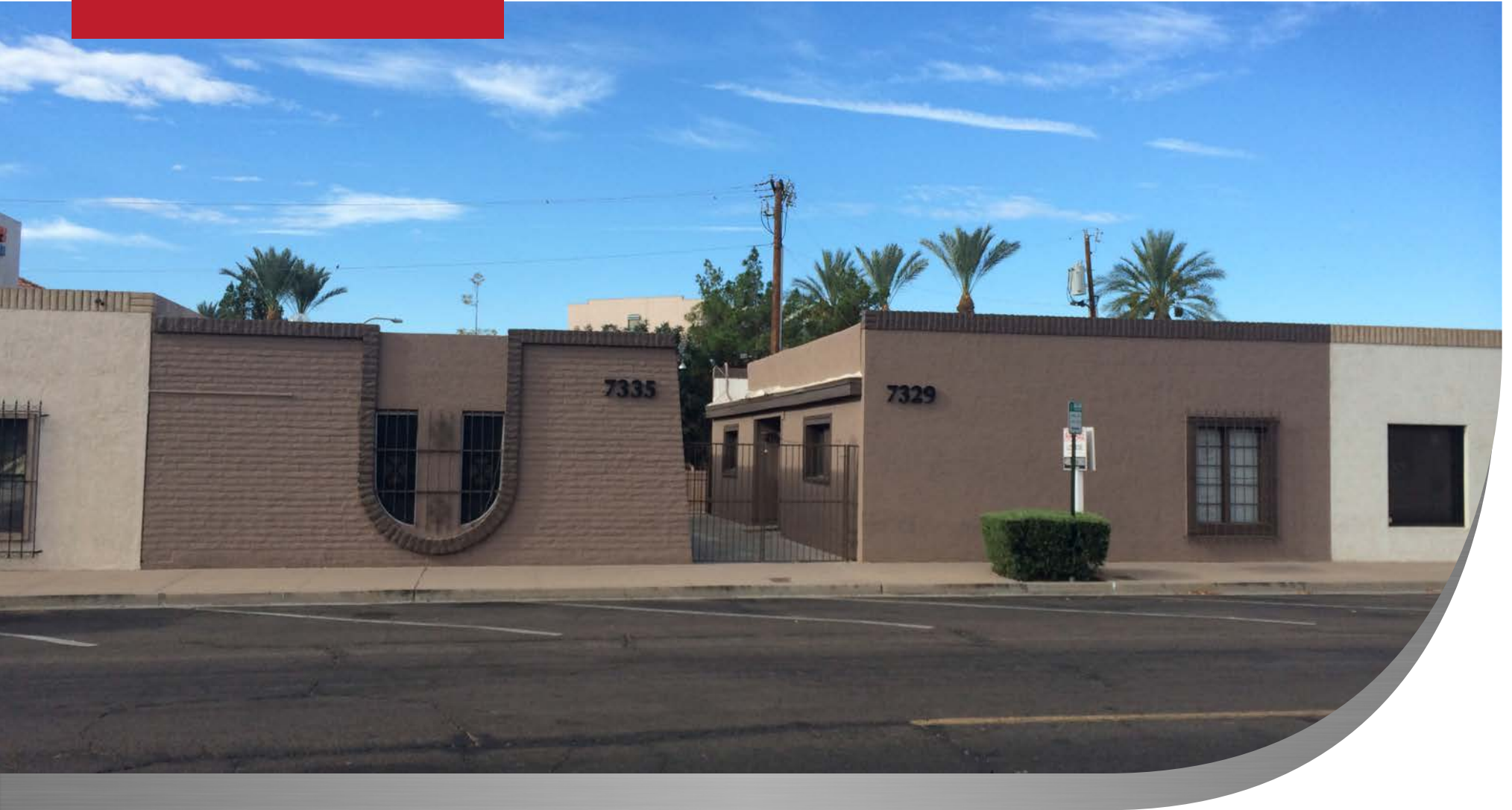

FOR MORE INFORMATION CONTACT:

**KELLY O' DEA**

480.294.6005

kodea@levrose.com

**LEVROSE**

COMMERCIAL REAL ESTATE 

4414 N. Civic Center Plaza, Suite 100  
Scottsdale, AZ 85251

T: 480.947.0600 | [www.levrose.com](http://www.levrose.com)

# 7329-7335 E. 6TH AVE | SCOTTSDALE, AZ 85251

PROPERTY DETAILS

### AVAILABILITY

7335 Suite 2	± 325 SF	\$550/Month, Full Service (net of janitorial)
7335 Suite 3&4	± 650 SF	\$1,050/Month, Full Service (net of janitorial)
7329 Entire Bldg	±1,300 SF	\$18.25/SF Modified Gross

### LEASE RATE

### HIGHLIGHTS

- Located in the heart of Old Town Scottsdale with Street Frontage
- Minutes from The Waterfront, Fashion Square Mall, Loop 101 & 202
- Central to Downtown’s Entertainment District and across from Luxury New Apartment Development.

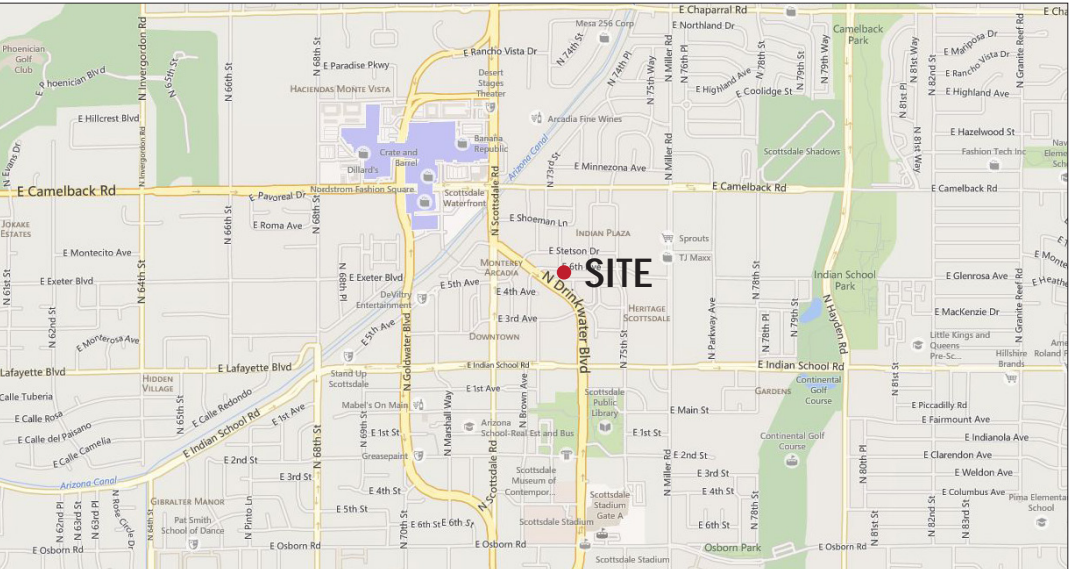

DEMOGRAPHICS	1 MILE	3 MILES	5 MILES
Avg. HH Income (2014)	\$64,903	\$74,613	\$73,028
Daytime Employees	44,835	87,950	180,515
Est. Population (2014)	16,935	87,531	170,959
Projected Pop. (2019)	18,894	93,769	196,519

FOR MORE INFORMATION CONTACT:

**KELLY O' DEA**  
 480.294.6005  
 kodea@levrose.com



4414 N. Civic Center Plaza, Suite 100  
 Scottsdale, AZ 85251  
 T: 480.947.0600 | www.levrose.com

This information has been secured from sources believed to be reliable, but no representations or warranties are made, expressed or implied, as to the accuracy of the information. References to square footage are approximate. Buyer and tenant must verify the information and bears all risk for any inaccuracies. All quoted prices are 1st year start rates and are subject to change without notice.