

# CORONADO COMMERCEPLEX III

## 420 NORTH 52ND AVENUE PHOENIX, ARIZONA

FOR LEASE



**+63,782 Square Foot Building**

Available: Suite 4 - 18,866 SF; 7 Docks

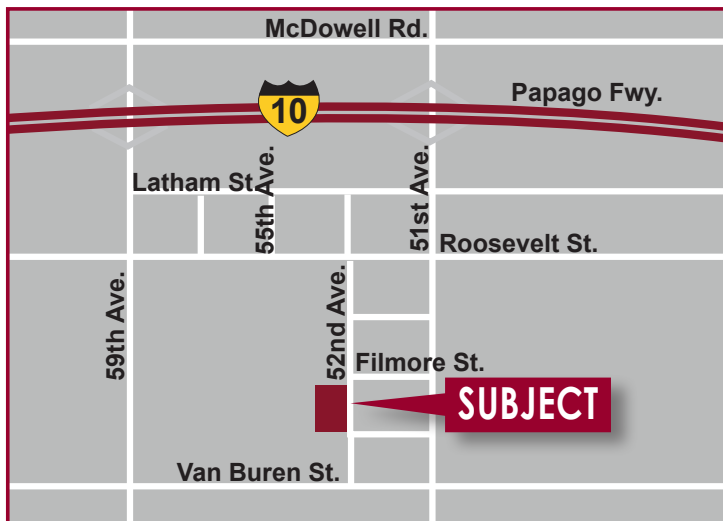

**LEE & ASSOCIATES®**  
COMMERCIAL REAL ESTATE SERVICES

3200 E. Camelback Rd.  
Suite #100  
Phoenix, Arizona, 85018  
ph: 602.956.7777 fx: 602.954.0510  
www.leeazona.com

**JEFF CONRAD**  
(602)954-3743  
jconrad@leeazona.com

**MATT HOBAICA**  
(602)954-3755  
mhobaica@leeazona.com

**EJM**  
EJM DEVELOPMENT CO.  
www.ejmdevelopment.com

All information furnished regarding property for sale, rental or financing is from sources deemed reliable, but no warranty or representation is made to the accuracy thereof and same is submitted to errors, omissions, change of price, rental or other conditions prior to sale, lease or financing or withdrawal without notice. No liability of any kind is to be imposed on the broker herein.

# CORONADO COMMERCEPLEX III

## 420 NORTH 52ND AVENUE PHOENIX, ARIZONA

FOR LEASE

### SUITE 4

- \$.41/SF NNN
- 18,866 SF
- 2,006 Square Feet of Office
- Reception / 3 Offices / 1 Break Room / 3 Restrooms
- 24' Clear Height
- 7 Dock Doors/1 Grade Level Door
- EVAP Cooled Warehouse
- A-1 Zoning

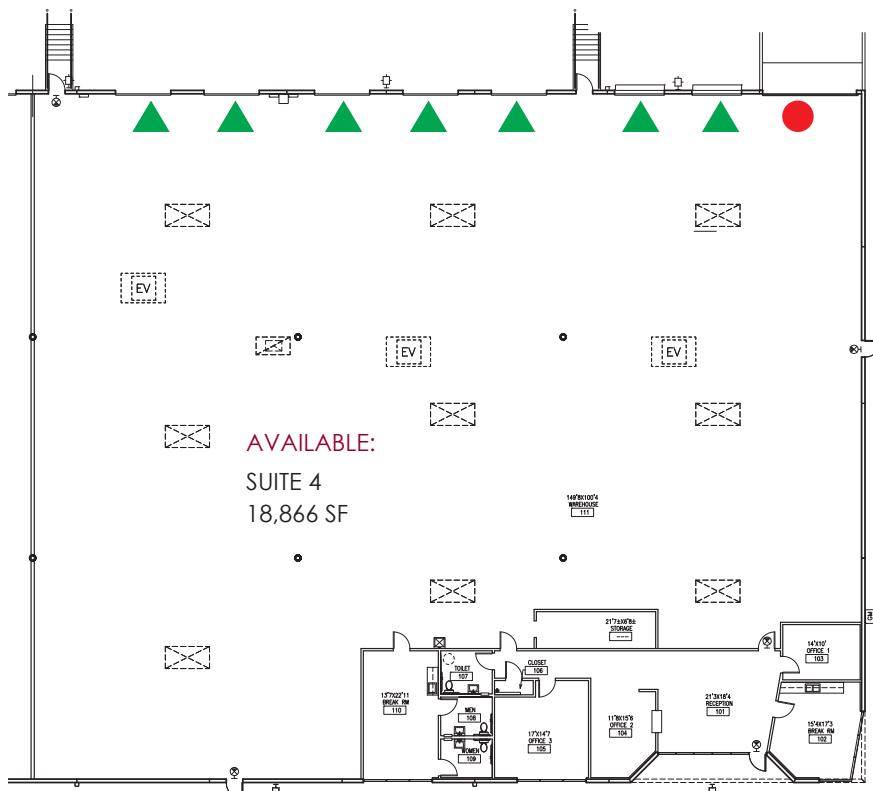
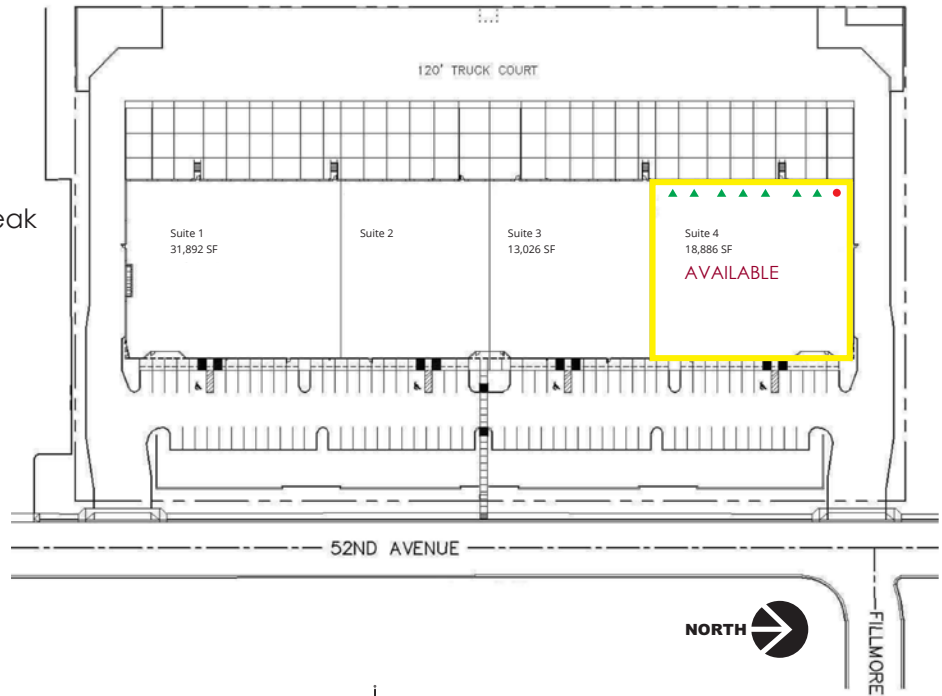

3200 E. Camelback Rd.  
Suite #100  
Phoenix, Arizona, 85018  
ph: 602.956.7777 fx: 602.954.0510  
www.learizona.com

**JEFF CONRAD**  
(602)954-3743  
jconrad@learizona.com

**MATT HOBAICA**  
(602)954-3755  
mhobaica@learizona.com



All information furnished regarding property for sale, rental or financing is from sources deemed reliable, but no warranty or representation is made to the accuracy thereof and same is submitted to errors, omissions, change of price, rental or other conditions prior to sale, lease or financing or withdrawal without notice. No liability of any kind is to be imposed on the broker herein.