

# 201 East Franklin Street Grapevine, TX 76051

## For Lease

**Total Size**  
9,000 SF

**Available Space**  
6,030 SF

**Rental Rate**  
\$15 PSF

**NNN Rate**  
\$2.35 PSF



### Location

Off Main Street in the Historical area of Downtown Grapevine.

### Features

Formerly CD Ski and Apparel. Located at the hub of the very busy Historic Main Street in Grapevine and directly next to the areas main public parking area.

**Jake Burns**

jake@structurecommercial.com

**Eric Deuillet**

eric@structurecommercial.com

**(214) 373-8300**

Demographics	1 Mile	3 Miles	5 Miles
Population	7,855	35,716	93,613
Annual HH Income	\$66,722	\$87,838	\$122,021

### Traffic Counts

South Main at East Franklin: 16,800 vehicles per day



**STRUCTURE  
COMMERCIAL**

www.structurecommercial.com

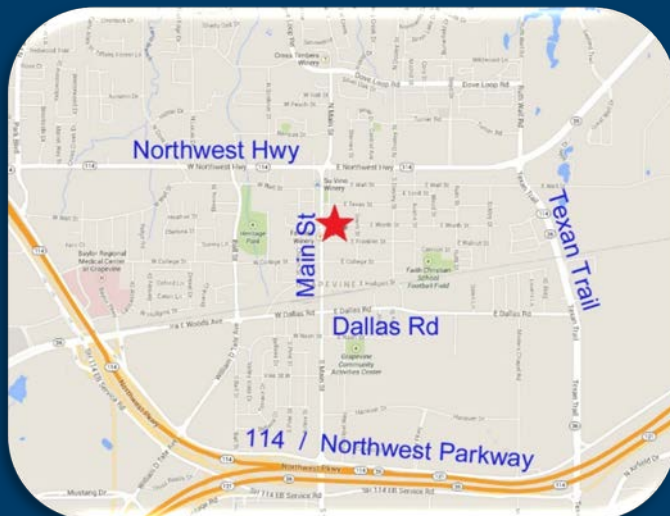

12740 Hillcrest Rd Suite 205, Dallas, TX, 75230 Phone (214) 373-8300

# 201 East Franklin Street Grapevine, TX 76051

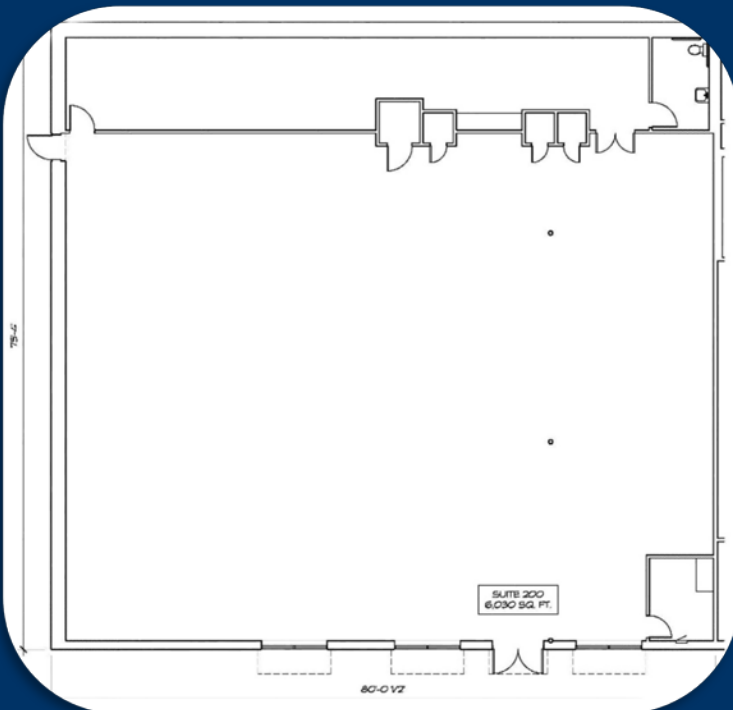
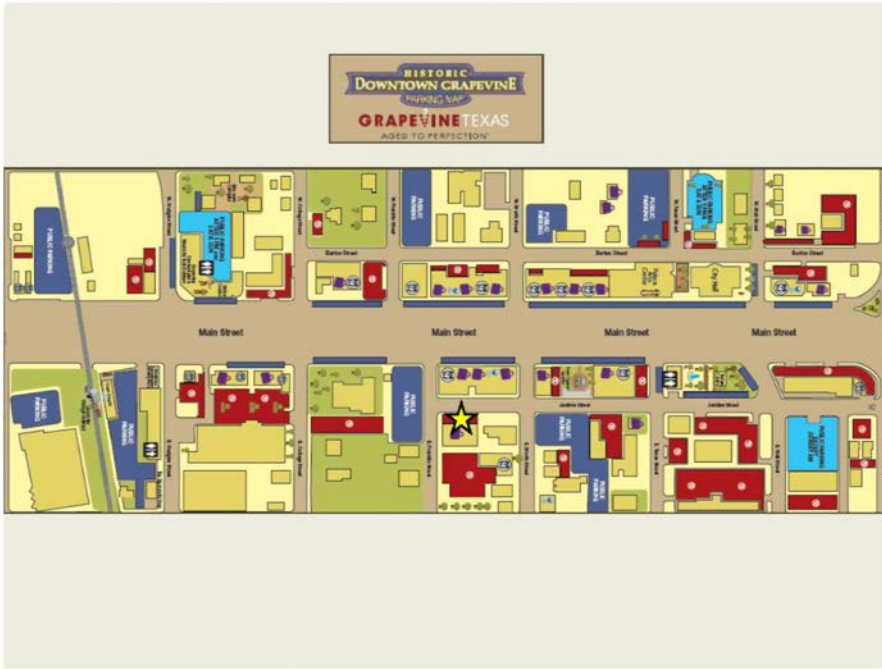

**Jake Burns**

[jake@structurecommercial.com](mailto:jake@structurecommercial.com)

**Eric Deuillet**

[eric@structurecommercial.com](mailto:eric@structurecommercial.com)

**(214) 373-8300**



**STRUCTURE  
COMMERCIAL**

[www.structurecommercial.com](http://www.structurecommercial.com)

The information contained herein was obtained from sources deemed reliable; however, Structure Commercial makes no guarantees, warranties, or representations as to the completeness or accuracy thereof. The presentation of this property is submitted subject to errors; omissions; change of price, prior to sale or lease; or withdrawal without notice.

